



Stainless Steel Hygiene Equipment



Hygiene Works was created as a result of over 50 years of manufacturing and design experience in food processing solutions.

We offer products and bespoke systems for personal hygiene applications. Our extensive knowledge in food processing, safety and hygiene allows us to create innovative turnkey solutions for personal hygiene.

With our group companies we have a unique offering with in-house design, engineering, manufacturing, automation, software, installation and service under one roof, making us the "one-stop shop solution partner of choice" for hundreds of food processing plants.

We develop stainless steel hygiene solutions in accordance with HACCP, IFS and BRC guidelines.

We are focused on becoming the partner of choice for hygiene and processing solutions within food industry.



Some of our Customers:



Guided Hygiene Stations

- Turnstile Hand Disinfection - p 4
- Entry Control Hygiene Stations - p 5-8
- Boot & Sole Cleaners and Dryers - p 9

Hygiene Equipment

- Dispensers for Disposables - p 10
- Changing Room Cabinets & Mats - p 11
- Washroom Accessories - p 12-14
- Sinks and Hand Wash Basins - p 15-16
- Knife Sterilisation - p 17

Other Equipment

- Mechanical Turnstiles - p 17
- Bespoke Stainless Steel Equipment - p 18-19

Sanitary Flow Systems

- Drain Gullies (Industrial) - p 20-22
- Drain Gullies (Commercial & Domestic) - p 23-24
- Drain Gullies (Insulated) - p 25
- Drainage Channels and Covers - p 26
- Drain Gullies Price List - p 27

Hand sanitise with turnstile (wall mounted)

Product code : *hsnt-1000-w*

Dimensions : *850 x 500 x 740 mm*

The hsnt-1000-w is an automatic dispenser unit with turnstile that reduces hygiene risks when entering production areas.

When both hands are inserted into the recesses, sensors activate the top and bottom nozzles that spray disinfectant to both sides of the hand to ensuring complete coverage. After this, the turnstile is released and one can proceed. The snt1000w is to be mounted to the wall and is suitable for disinfectant (*not suitable for gel type disinfectants*). Stainless Steel 304 grade.

Benefits

- Reduces contamination risks
- Wall or floor mounting
- Adjustable two-sided chemical dosing from 4 nozzles
- Red and green led access lights
- Disinfectant dosing amount adjustable
- Can be connected to external devices such as card readers
- Turnstile entry direction is adjustable



Hand disinfection with turnstile (floor mounted)

Product code : *hsnt-1000-f*

Dimensions : *1000 x 500 x 1400 mm*

- Combination unit with hand rail and hygienic mat for sole disinfection



Hand wash, sanitise and sole disinfection with turnstile



The snt-1200 offer economical design with hand wash and disinfection before entering production areas.

Consists of a grid base platform with knee operated sink, soap dispenser, paper towel dispenser and bin, This is followed by a 2-hand- disinfection unit and a turnstile with a hygienic mat for sole disinfection. The system grants access after hand disinfection has been accomplished. Stainless Steel 304 grade. Single unit suitable for 20-30 people/shift.

Benefits

- Reduces contamination risks
- All in one unit
- Red and green led access lights
- Economical design

Product code : snt-1200

Dimensions : 1100 x 2000 x 1800 mm

Twin hand wash, sanitise and sole disinfection with turnstile



The snt-1200 -t offer economical design with twin hand wash and disinfection before entering production areas. Consists of a grid base platform with sensor operated sink and soap dispenser, manual paper towel dispenser and bin. This is followed by a 2-hand- disinfection unit and a turnstile with a hygienic mat for sole disinfection. The system grants access after hand disinfection has been accomplished. Stainless Steel 304 grade. Single unit suitable for 40-50 people/shift.

Benefits

- Reduces contamination risks
- All in one unit
- Red and green led access lights
- Economical design
- Increased entry rate

Product code : snt-1200-t

Dimensions : 1250 x 2800 x 1800 mm

Hand soap, wash, dry and sanitise with turnstile (wall mounted)

The snt-1100-w offer the optimal hand hygiene with turnstile before entering production areas. Consists of sensor activated hand washing channel with integrated automatic soap dispenser operating in sequence. A sensor activated high speed hand dryer is integrated in the casing followed by a 2-hand-disinfection unit and a turnstile that grants access after all all of the above steps have been accomplished. Stainless Steel 304 grade. Single unit suitable for 20-30 people/shift.

Benefits

- All in one hand hygiene
- Wall or floor mounting
- Paper free
- Red and green led access lights
- Integrated hand wash and soap dispensing.

Product code : snt-1100-w

Dimensions : 1000 x 1250 x 800 mm

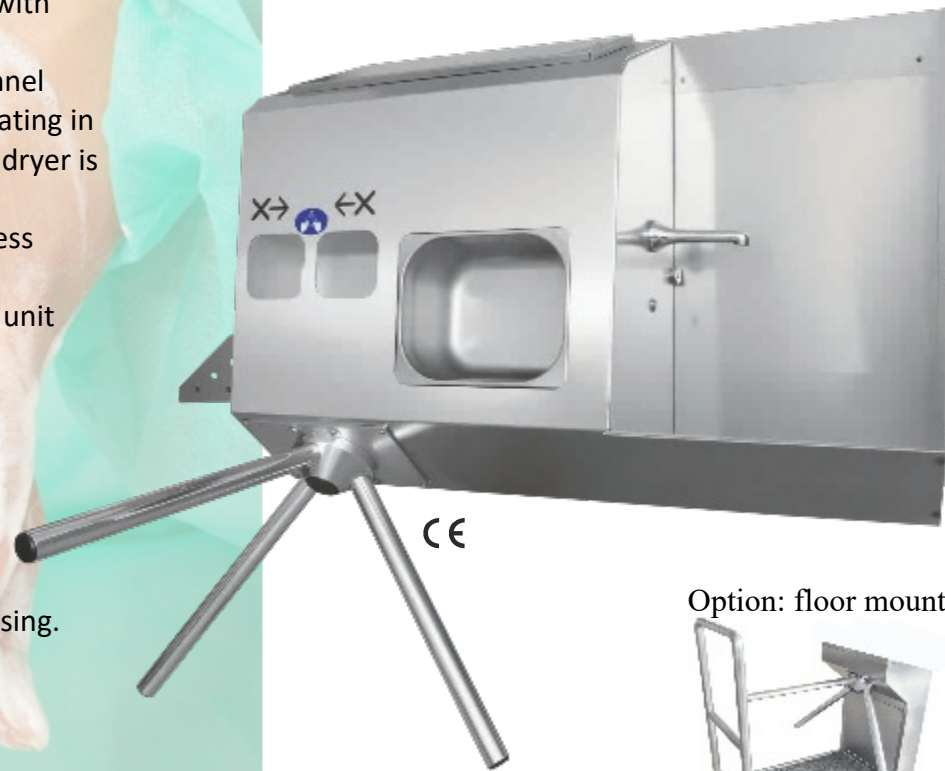

Option: floor mount

* floor mounted unit + £300 (snt-1100-f) comes with hand rail and hygienic mat for sole disinfection

Sole clean, disinfection and hand sanitise with turnstile

The snt-1210 offer the optimal cleaning of shoe soles and hand sanitation before entering production area. Consists of sensor activated two horizontal brushes with safety grid cover offering fast, efficient sole cleaning. Brush rotation speed and auto cleanser spray nozzles for the brushes are adjustable. This is followed by a 2-hand-disinfection unit with a hygienic floor mat used with disinfectant and a turnstile that only grants access after all all of the above steps have been accomplished. Stainless Steel 304 grade. Single unit suitable for 50-60 people/shift.

Benefits

- Combo unit - sole clean and hand hygiene
- Can be connected to external devices such as card readers
- Turnstile entry direction is adjustable
- Red and green led access lights

Product code : snt-1210

Dimensions : 1100 x 2000 x 1800 mm

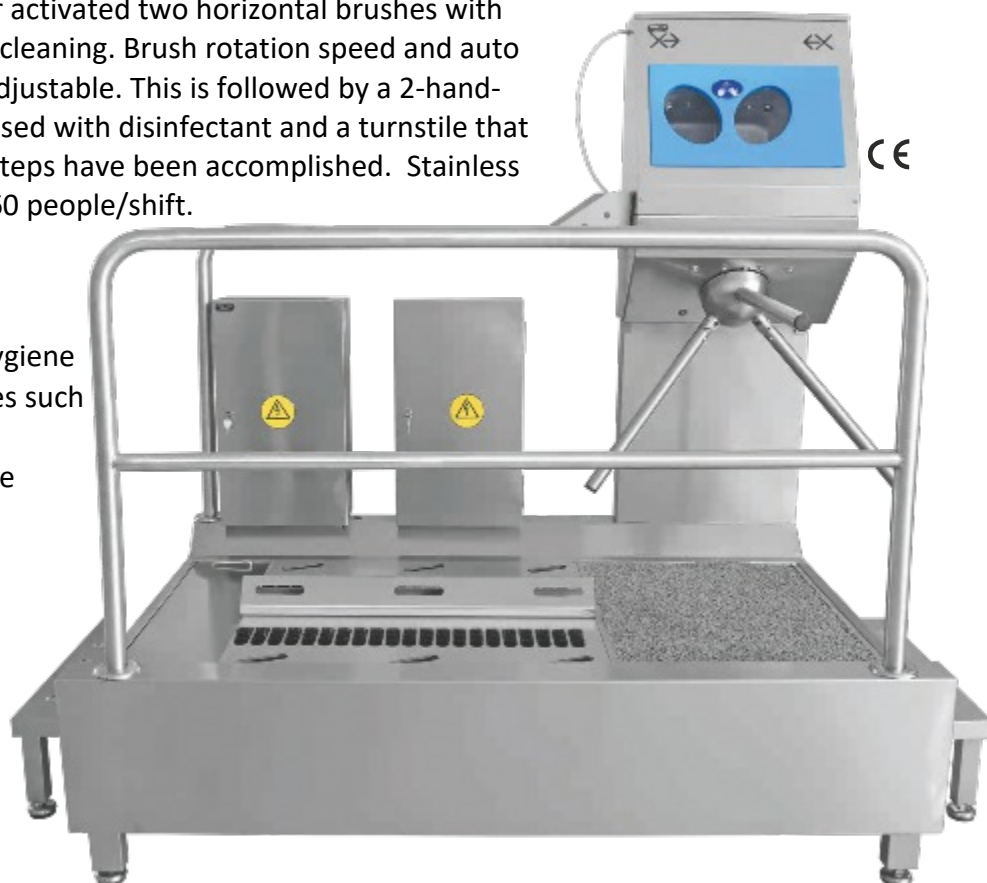

Sole clean, disinfection and hand hygiene with turnstile

The snt-1220 offer the optimal cleaning of shoe soles and hand hygiene before entering production area. Consists of knee operated hand wash with auto soap dispenser, a 2-hand- disinfection unit with a hygienic floor mat, a turnstile and sensor activated two horizontal brushes with safety grid cover offering fast, efficient sole cleaning. Brush rotation speed and auto cleanser spray nozzles for the brushes are adjustable. Stainless Steel 304 grade.

BESPOKE CUSTOMER DESIGNS



Benefits

- Combo unit - sole clean and complete hand hygiene
- Can be connected to external devices such as card readers
- Turnstile entry direction is adjustable
- Red and green led access lights

Product code : snt-1220

Dimensions : Customer specific

Sole and side clean, disinfection and hand hygiene with turnstile

BESPOKE CUSTOMER DESIGNS

Product code : snt-1230

Dimensions : Customer specific

The snt-1230 offer the optimal cleaning of boot soles and high sides with sensor activated horizontal and vertical brushes with safety grid cover offering fast, efficient sole cleaning. This is followed by a knee operated hand wash with auto soap dispenser, a 2-hand- disinfection unit with a turnstile and hygienic floor mat before entering production area. Turnstile only grants access after all all of the above steps have been accomplished. Brush rotation speed and auto cleanser spray nozzles for the brushes are adjustable. Stainless Steel 304 grade.

Benefits

- Combo unit - sole, side clean and complete hand hygiene
- Can be connected to external devices such as card readers
- Turnstile entry direction is adjustable
- Corner entry application
- Red and green led access lights



Sole and side clean, disinfection and hand hygiene with turnstile



The snt-1230 offer the optimal cleaning of boot soles and high sides with sensor activated horizontal and vertical brushes with safety grid cover offering fast, efficient sole cleaning. This is followed by a knee operated hand wash with auto soap dispenser, a 2-hand- disinfection unit with a turnstile and hygienic floor mat before entering production area. Turnstile only grants access after all all of the above steps have been accomplished. Brush rotation speed and auto cleanser spray nozzles for the brushes are adjustable. Stainless Steel 304 grade.

Product code : snt-1240

Dimensions : 1100 x 2800 x 1800 mm

Benefits

- Combo unit - sole and sides clean and complete hand hygiene
- Can be connected to external devices such as card readers
- Turnstile entry direction is adjustable
- Red and green led access lights

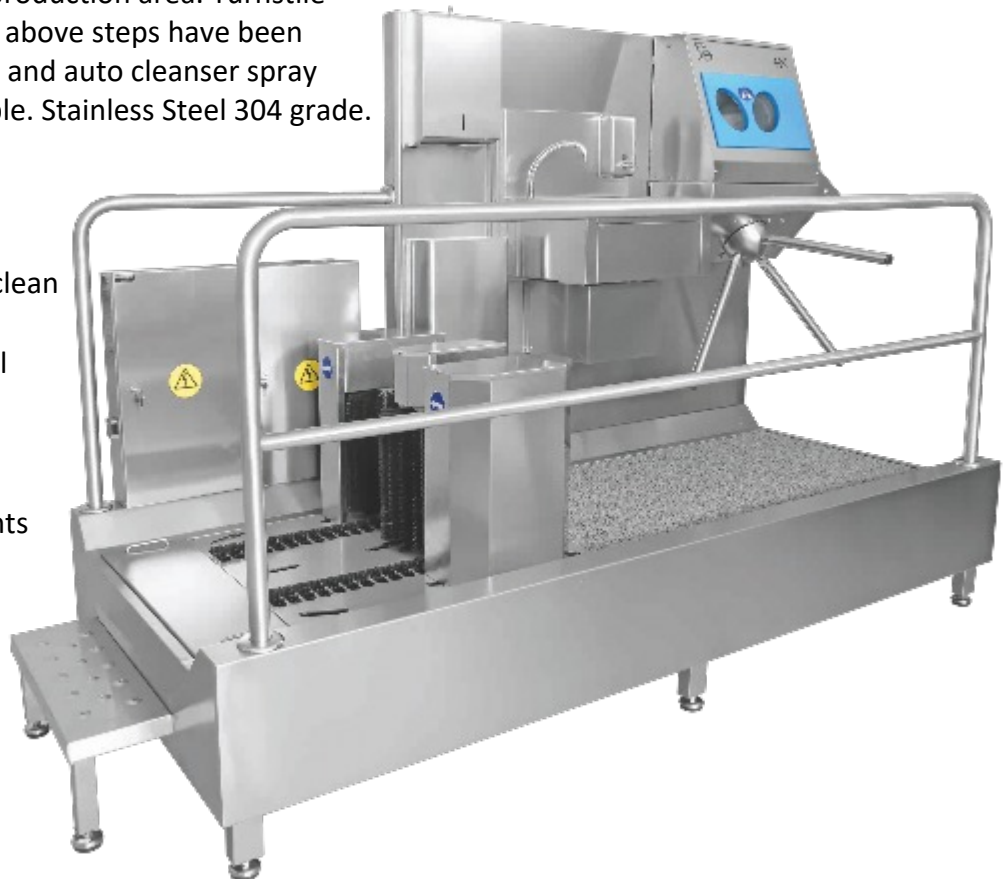

Sole Cleaner

Sole & Sides Cleaner



Product code : bsnt-1300
Dimensions : 1100 x 1500 x 1100 mm

The bsnt - 1300 includes two rotating horizontal brushes for sole cleaning. The brushes are sprayed with water and cleanser, which is automatically activated when the operator steps onto the machine platform. Can be used with guided turnstile systems to guarantee that all personnel have sanitised soles before entering production areas. Different lengths are available.



Product code : bsnt-1310
Dimensions : 1100 x 1500 x 1100 mm

The bsnt - 1310 includes rotating horizontal brushes for sole cleaning and vertical brushes for sides cleaning. The brushes are sprayed with water and cleanser, which is automatically activated when the operator steps onto the machine platform. Can be used with guided turnstile systems to guarantee that all personnel have sanitised complete footwear before entering production areas.

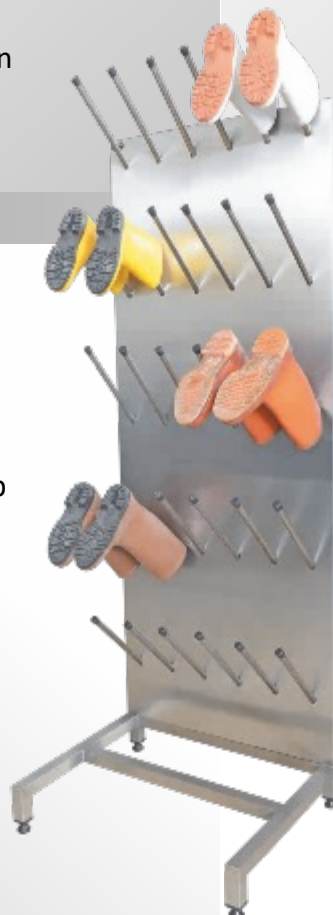

Boot Racks and Dryers

15, 20, 30 Pair models

Boot Racks:

The boot storage racks are floor mounted and made entirely from stainless steel. The boots can be hung up easily with individual storage prongs. Different sizes and capacities available

Product code : br-15f
Dimensions : 650 x 750 x 1900 mm

Boot Dryers:

Boot Dryer is for floor mounting and features a switch for manual or automatic operation. The drying time is adjustable.

Product code : brd-15f
Dimensions : 650 x 750 x 1900 mm

• Dispensers for Disposables:

Large



Product code: dsp-1w



Product code: dsp-2w



Product code: dsp-3w

Wall mounted single & multi disposable dispensers

Large



Product code: dsp-3combo-w

Wall mounted hair net, glove, snood cover and overcoat dispenser/bin

Large

Product code: dsp-3combo-f



BESPOKE CUSTOMER DESIGNS

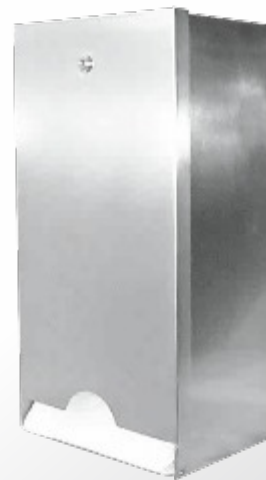

Product code: dsp-1cw

Size: 250 x 170 x 500 mm

Wall mounted single overcoat dispenser

Product code: gd-1



Single, twin, triple glove dispenser

Overcoat Sterilization Cabinet - Twin

Stainless Steel lockers



Product code: slkr-2f

Size: 1800 x 700 x 500 mm

The slkr - 2f is designed to sterilize staff and visitor overcoats with the help of UVC Light. It is time adjustable Stainless Steel 304 grade.



Product code: lkr-1f



Product code: lkr-3f

The lkr range of stainless steel lockers are designed to be used in changing rooms. Bespoke room and cabinet designs are available. Stainless Steel 304 grade.

Sole Disinfection mat with stainless steel enclosure



Product codes:

hm-s: 400 x 600 mm (small) -

hm-l: 600 x 900 mm (large) -

The hm-s is designed to disinfect soles of shoes before entering or exiting risk areas. The QAC based disinfectant is used on the hygienic sponge mat and replaced regularly depending on usage . Can be produced in bespoke sizes depending on customer needs.

Areas of use:

- Food processing areas, general food areas, depots, toilets
- Food packaging, pharmaceutical production and depot areas.
- Hotels, Spa's, Gym's
- Hospitals, operation rooms, clinics, general practices
- Schools, food halls

Soap and Disinfectant Dispensers:

Product code: sds-mw



Soap dispenser - 1000 ml

Polished or Matt

Product code: fds-mw



Foam dispenser - 1000 ml

Polished or Matt

Product code: dsl-a



Disinfectant Spray - sensor operated

Holds 5 000 ml disinfectant bottle

Product code: dss-a



Disinfectant Spray - sensor operated

1000 ml

Product code: sdd- m



Soap or disinfectant dispenser

1000 ml

Product code: sds-mf



Soap dispenser

Paper Dispensers



Product code: td-s

Towel dispenser with lock
Holds 200 sheets
304 grade stainless steel



Product code: td-l

Towel dispenser with lock
Holds 400 sheets
304 grade stainless steel



Product code: tdfb-l

Towel dispenser and bin combo
Holds 400 sheets
304 grade stainless steel



Product code: tdob-l

Towel dispenser and oval bin
combo
Holds 400 sheets



Product code: tsd-l

Toilet seat cover dispenser
304 grade stainless steel



Product code: trd-xl

Jumbo toilet roll dispenser
With lock
304 grade stainless steel

Hand Dryers - Sensor operated

Product code: hd-w



White Epoxy Paint

Power : 2400 W

Product code: hd-sm



Stainless Steel Matt

Power : 2400 W

Product code: hd-sp



Stainless Steel Polished

Power : 2400 W

Industrial Bins



Product code: *ib-p90*

Capacity: 90 Lt
400x730 mm with pedal
304 grade stainless steel



Product code: *ib-p70*

Capacity: 70 Lt
400x630 mm with pedal
304 grade stainless steel



Product code: *ib-p50*

Capacity: 50 Lt
400x500 mm with pedal
304 grade stainless steel



Product code: *ib-p40*

Capacity: 40 Lt
400x400 mm with pedal
304 grade stainless steel



Product code: *ib-fl54*

Capacity: 54 Lt with float lid
790x290x90 mm
304 grade stainless steel



Product code: *ib-fl36*

Capacity: 36 Lt with float lid
580x290x90 mm
304 grade stainless steel



Product code: *ib-fl16*

Capacity: 16 Lt with float lid
440x220x220 mm
304 grade stainless steel



Product code: *ib-fl11*

Capacity: 11 Lt with float lid
380x190x170 mm
304 grade stainless steel

• Sinks & Hand Wash Basins:

Product code: hw-1mw



Knee Operated Hand Wash Basin

Product code: hwd-1sw



Decorative Sensor Operated Hand Wash Basin
With Soap Dispenser

Product code: hws-1pf



Twin Pedal Operated Hand Wash Sink (production area)

Product code: hws-1mf



Knee Operated Hand Wash Basin and soap dispenser

Product code: hws-1sf



Sensor operated Hand Wash Sink Stand

Product code: hws-1pfc



Twin Pedal Operated Hand Wash Sink with Cupboard

Product code: hws-2sf



Sensor operated Twin Hand Wash & soap dispenser Sink Stand

Product code: hws-1combo



Floor mounted sensor operated Combination Sink with Towel, Soap, Disinfectant dispensers and bin

Product code: hws-3pfs



Twin Pedal Operated Triple Hand Wash Sink Stand with 2 soap dispensers

Product code: bws-1mf



Bottle Washing and Draining Sink

Product code: ews-1mf



Twin Pedal Operated Equipment Washing Sink with Tap and Pre-rinse Spray

UVC Knife Sterilisation Box

Product code: uvks-10



10 Knife cabinet with timer (20 knife model available)
The units contain a tube that generates ultraviolet germicidal rays transforming oxygen into ozone, thus killing bacteria.
Stainless Steel 304 Grade

Knife Basket Sterilisation

Product code: rhks-10



10 Knife basket Steriliser contains resistance heater for water to disinfect the knives. The knives are placed in a basket which is removable. The operation is via an exterior mounted operating unit with on/off-switch and red indicator lamp
Stainless Steel 304 Grade

Mechanical Tripod Turnstile

Product code: mt-f



Floor mount.
Stainless Steel 304 Grade

Swing Gate Turnstile

Product code: ms-f



Floor mount.
Stainless Steel 304 Grade

Contact us for all your stainless steel hygiene equipment needs

- Food processing areas, general food areas, depots, toilets
- Food packaging, pharmaceutical production and depot areas.
- Hotels, Spa's, Gym's
- Hospitals, operation rooms, clinics, general practices
- Schools, food halls



Contact us for all your stainless steel hygiene equipment needs

- Food processing areas, general food areas, depots, toilets
- Food packaging, pharmaceutical production and depot areas.
- Hotels, Spa's, Gym's
- Hospitals, operation rooms, clinics, general practices
- Schools, food halls



Sanitary Flow Systems

Flowell sanitary stainless steel drains and channels for use in food, dairy, beverage, chemical and pharmaceutical plants.

- Fully glass bead blasted.
- Available in AISI 304 or 316 grade stainless steel
 - Simple design for utmost hygiene
 - Easy and quick maintenance and cleaning.
- Wide range of designs and styles
- Bespoke channel designs for varying plant installations
- Engineering drawings for flooring

"Versatile Solutions For Industrial & Domestic Applications"

ROBUST



PSG 110A



LOW COST



PSG 110B, PSG 110C

Most versatile solutions for industrial applications

HIGH CAPACITY



PSG 110V



SMALL BUT ROBUST



PSG 51VK, PSG 76VK

FLOWELL®

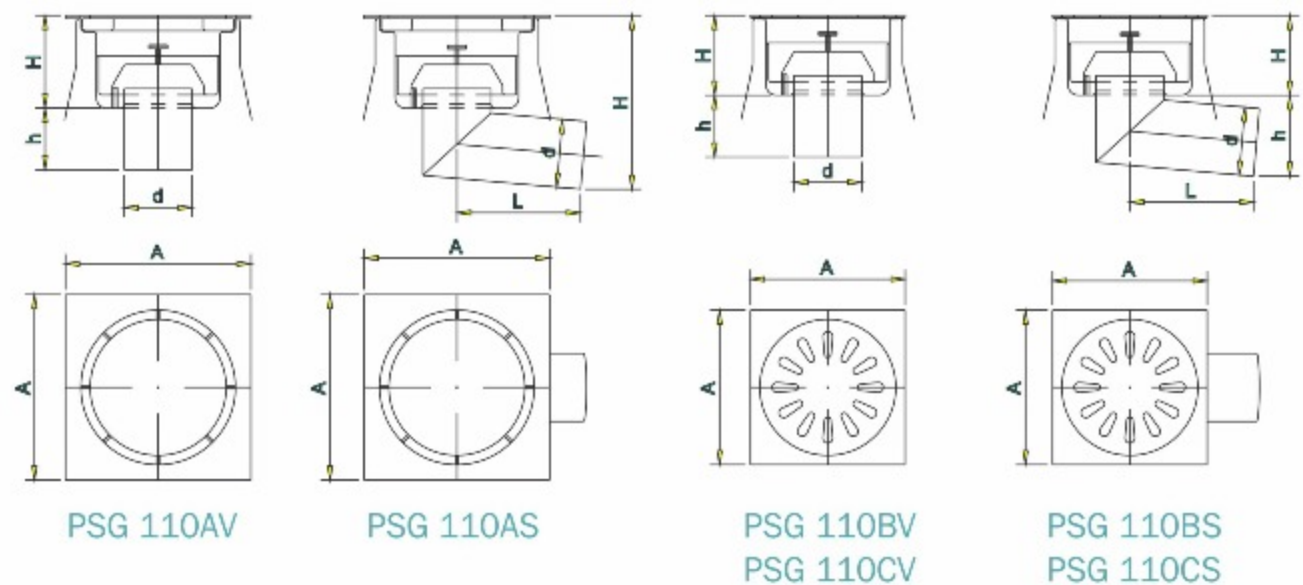
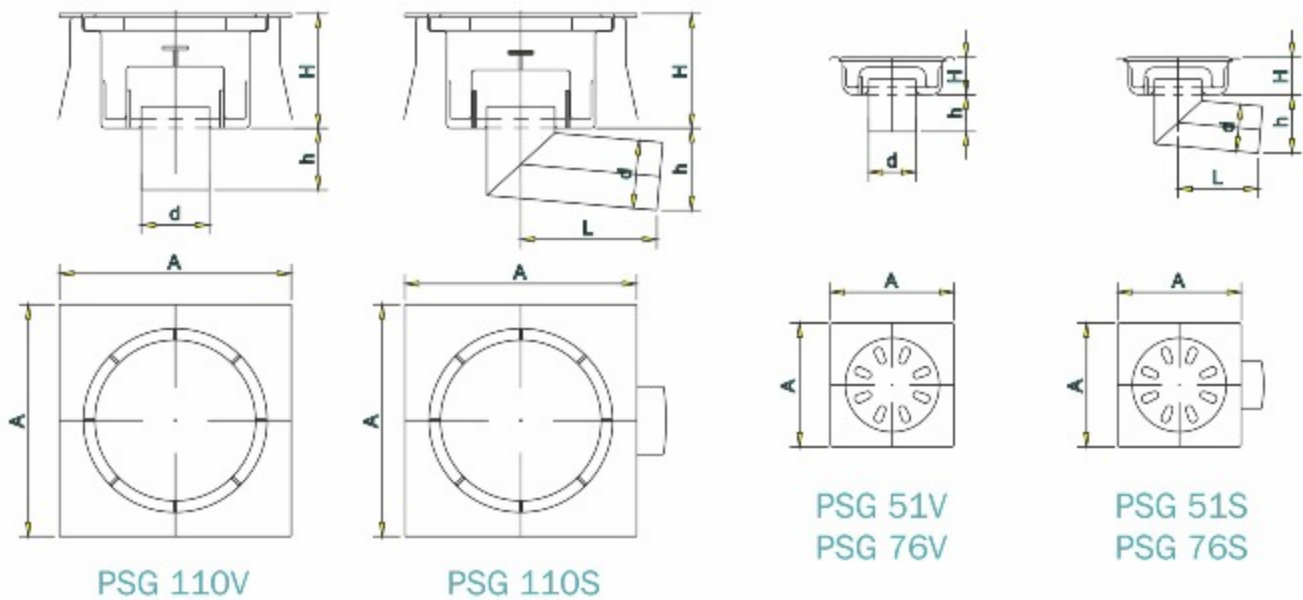

TiP - TYPE	A (mm)	d (mm)	H (mm)	h (mm)	L (mm)
PSG 51V	200	51	60	60	-
PSG 76V	200	76	60	60	-
PSG 110AV	300	110	150	100	-
PSG 110BV	250	110	129	100	-
PSG 110CV	250	110	104	100	-
PSG 110V	375	110	185	100	-
PSG 51S	200	51	60	64	118
PSG 76S	200	76	60	95	130
PSG 110AS	300	110	150	131	200
PSG 110BS	250	110	129	131	200
PSG 110CS	250	110	104	131	200
PSG 110S	375	110	185	133	220

Where ^{the} elegance
and functionality
meets!



PSG TIP 10



PSG TIP 15



PSG TIP 20

■ Hygienic and versatile solutions for homes, offices, hotels, hospitals and wherever needed.

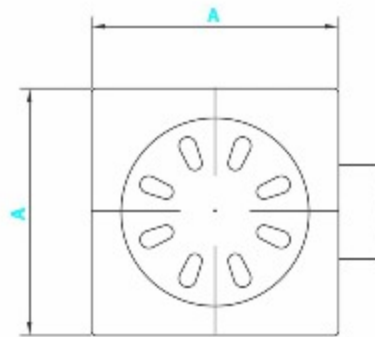
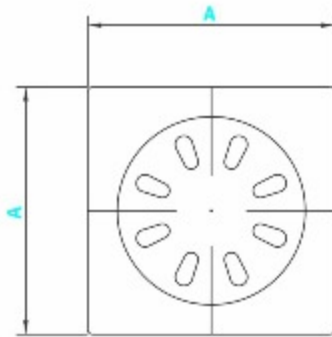
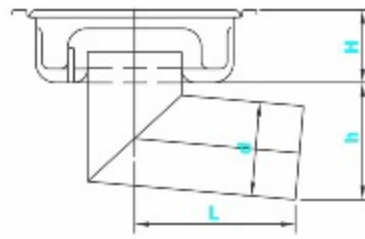
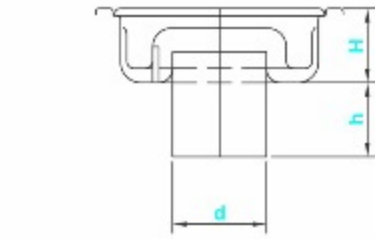

PSG TIP 20V

PSG TIP 20S

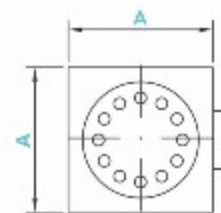
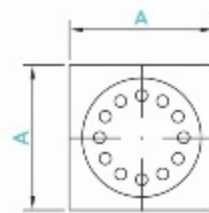
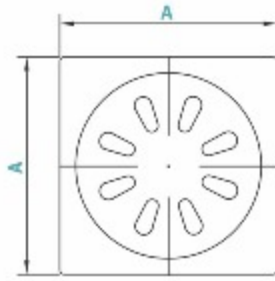
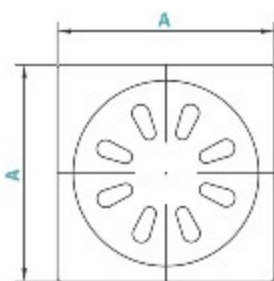
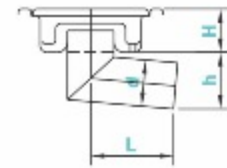
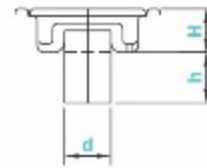
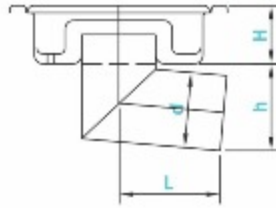
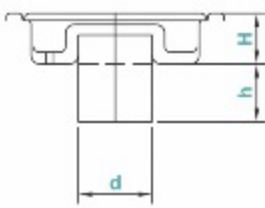

PSG TIP 15V

PSG TIP 15S

PSG TIP 10V

PSG TIP 10S

TIP - TYPE	A (mm)	d (mm)	H (mm)	h (mm)	L (mm)
PSG TIP 10V	100	32/40	30	35	-
PSG TIP 15V	150	51	40	40	-
PSG TIP 20V	200	51/76	60	60	-
PSG TIP 10S	100	32/40	30	39/47	57
PSG TIP 15S	150	51	40	60	70
PSG TIP 20S	200	51/76	60	64/95	118/130

Insulated Floor Gullies

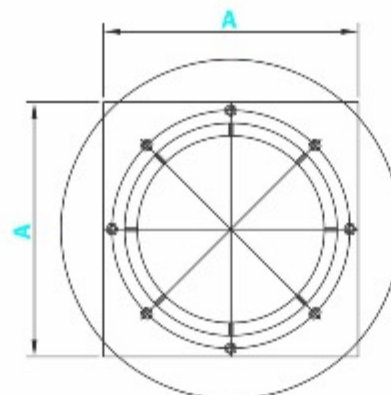
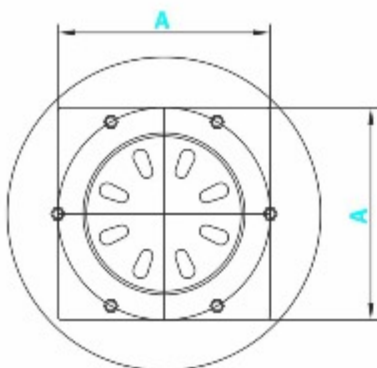
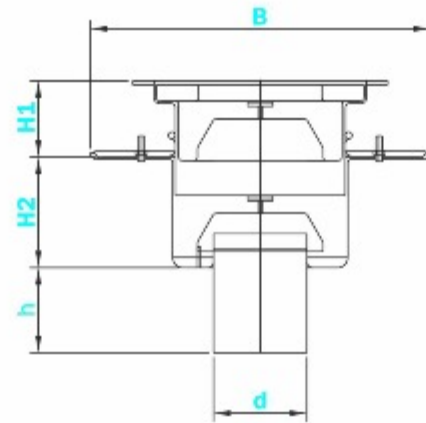
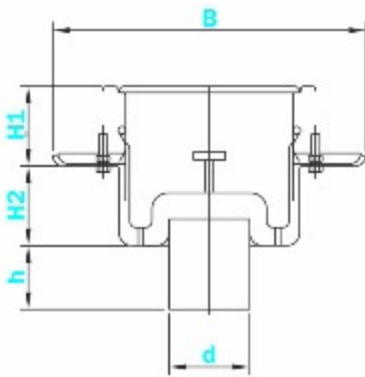

PSG-S 50
PSG-S 76 V

PSG-S 110V

TIP - TYPE	A (mm)	d (mm)	B (mm)	H1 (mm)	H2 (mm)	h (mm)
PSG-S 50V	200	50	295	75+30	75	60
PSG-S 76V	200	76	295	75+30	75	60
PSG-S 110V	300	110	400	90+30	130	100

Drainage Channels

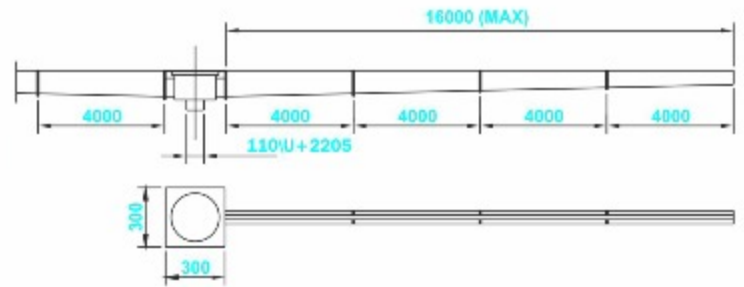

PSK 22/70 + PSG 110AVF

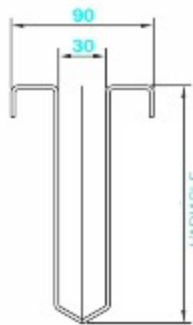

PSK 30/90 + PSKG 110AV

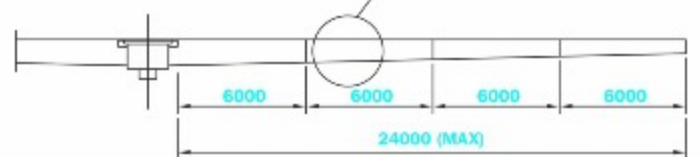
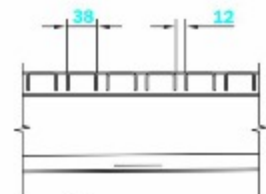
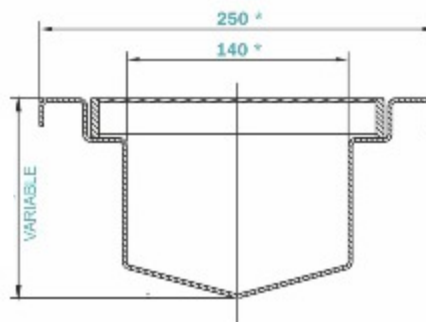

PSK 140+ PSKG 110AV

Subject to change according to the customers needs.

hygiene - WORKS

Contact Us:

Hygiene Inox Limited

Sadler Street, Middleton, Manchester M24 5UJ. United Kingdom

Tel: +44 (0) 161 2497010

email: vicky@hygieneworks.co.uk

www.hygieneworks.co.uk

